

# COATS



## Model 775

- 1 Integrated LED Matrix Display**  
Easy-to-read visual cues and keypad promote proper balancing techniques and faster bay turnaround times.
- 2 10 Balancing Modes**  
Multiple static, dynamic, and alloy modes.
- 3 Self-Calibrating**  
Provides balancing accuracy within 1/100 of an ounce.
- 4 Space Saving Design**  
Put your balancing station virtually anywhere.
- 5 Tape-A-Weight and Hidden Weight Capability**  
Comes standard on both platforms.
- 6 40 mm Shaft**  
Uses all standard Coats accessories!

## Model 875

- 7 Automatic Distance & Diameter Entry**  
Automatic measurement of two parameters with manual control back-ups.
- 8 Auto Start Hood**  
Balancing cycle begins when you lower the hood.
- 9 Expanded Storage**  
A 17-pocket weight tray provides easily reachable, abundant storage.
- 10 Direct Tape-A-Weight Placement**  
Audible beep guides you to perfect placement, every time.

# Model 875 & 775 Wheel Balancers

## Discover Coats® Light and Medium Duty Balancers.

These little dynamos get you started in a big way.

Offering wheel balancing to your customers is a great way to add new revenue to your business. You stay more competitive and keep balancing service in your shop... where it belongs.

The Coats® 775 is a great place to start. This unit is designed for low volume occasional balancing of OE fitments but offers features you will find on much more elaborate machines.

The Coats® 875 offers a step up to medium volume of OE fitments with more features like Automatic Distance & Diameter Entry and Direct Tape-A-Weight Placement—so you speed up your process to meet increasing demand.

Both of these innovative balancers will give you years of rugged durability, dependability, and performance... all for a value price.

### Integrated LED Matrix Display

With a convenient, easy-to-read keypad entry system and self calibration accuracy within 1/100 of an ounce, balancing is fast and efficient even for a rookie. Can handle standard OEM tires up to 40" diameter and 100 lbs. (130 lbs. on the Model 875)

### Space Saving Design

The 775 and 875 balancers are "small footprint" so they will fit almost anywhere. That also gives you the flexibility to fine tune your workflow process as you grow more easily.

### Tape-A-Weight and Hidden Weight Capability

These features, usually found on much bigger balancers, come standard on both models. These modes help keep weights out of sight for OE alloys.

## Model 775



## Model 875



### Direct Tape-A-Weight Placement

Audible beeps indicate exact placement of Tape-A-Weights and take the guesswork out of those tricky behind-the-spoke balances.

### Automatic Distance & Diameter Data Entry

Automatic offset and diameter measurements make every balancing job quick and precise.

### Hood with Integrated Auto Start

Lowering the protective hood starts the balancing process and offers additional protection.



# MODEL 775 & 875 WHEEL BALANCERS

## Specifications

### Part Number

85007775 (Model 775)  
85008875 (Model 875)

### Balancing Modes

10

### Maximum Tire Diameter

34" to 40"

### Rim Width

2" to 20"

### Rim Diameter

Up to 30"

### Maximum Tire Weight

100 lbs. to 130 lbs.

### Shaft Diameter

40 mm

### Balancing Speed

100 RPM

### Motor

110v, 1Ph

### Shipping Weight

198 lbs. (Model 775)  
213 lbs. (Model 875)

## Standard 40 mm Accessories

- Small Cone
- Medium Cone
- Large Cone
- Light Truck Back Cone
- Calipers
- Premium Wheel Weight Hammer
- Hub Nut
- Small Pressure Cup & Rubber Lip
- Spring
- Stub Shaft

## Optional 40 mm Accessories

- Slide Nut Kit - 8113328
- In-Between Cone Set - 8113795
- Light Truck Front Cone Kit - 8113277C

### **HENNESSY** INDUSTRIES, INC.

Manufacturer of Ammco®, Coats® and BADA® Automobile Service Equipment, Tools and Accessories.

1601 J.P. Hennessy Drive  
LaVergne, TN 37086-3565  
800-688-6496 or 615-641-7533

### **Hennessy Canada**

2430 Lucknow Drive, Unit #9  
Mississauga, Ontario L5S 1V3  
905-672-9440 Printed in USA.

[www.ammcoats.com](http://www.ammcoats.com)

Part No. 85008943 Rev.1 11/07

## The Coats® 775 and 875 Balancers bring professional balancing service to your lineup.

Whether you own a brake shop, muffler shop, or are just starting out with a couple of bays, the 775 and 875 models are a cost effective way to provide wheel balancing for your customers. It is a profitable part of any shop that can pay for itself in short order while encouraging repeat business. And Coats® will help you get started without breaking the bank. These models offer big league features in a compact size and the built-in dependability from the leader in the tire service business – Coats.

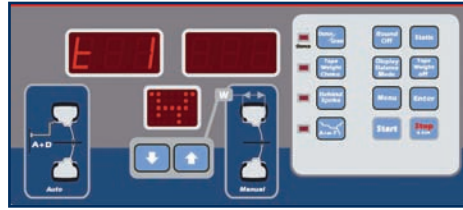

Integrated LED Matrix Display  
Model 875

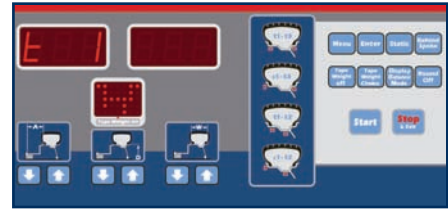

Integrated LED Matrix Display  
Model 775



Auto Start Hood



17-Pocket Weight Tray

| FEATURES to be compared             | MODELS |     |
|-------------------------------------|--------|-----|
|                                     | 775    | 875 |
| SELF-CALIBRATING                    | ●      | ●   |
| AUTOMATIC DISTANCE & DIAMETER ENTRY |        | ●   |
| HOOD START                          |        | ●   |
| TAPE-A-WEIGHT CAPABILITY            | ●      | ●   |
| HIDDEN WEIGHT CAPABILITY            | ●      | ●   |
| DIRECT TAPE-A-WEIGHT PLACEMENT      |        | ●   |
| WHEEL GUARD                         |        | ●   |
| BALANCER SHAFT: 40 MM               | ●      | ●   |
| MAX TIRE WEIGHT: 100 LBS.           | ●      |     |
| 130 LBS.                            |        | ●   |
| SHIPPING WEIGHT: 198 LBS.           | ●      |     |
| 213 LBS.                            |        | ●   |
| OZ/GRAM SELECTABLE                  | ●      | ●   |